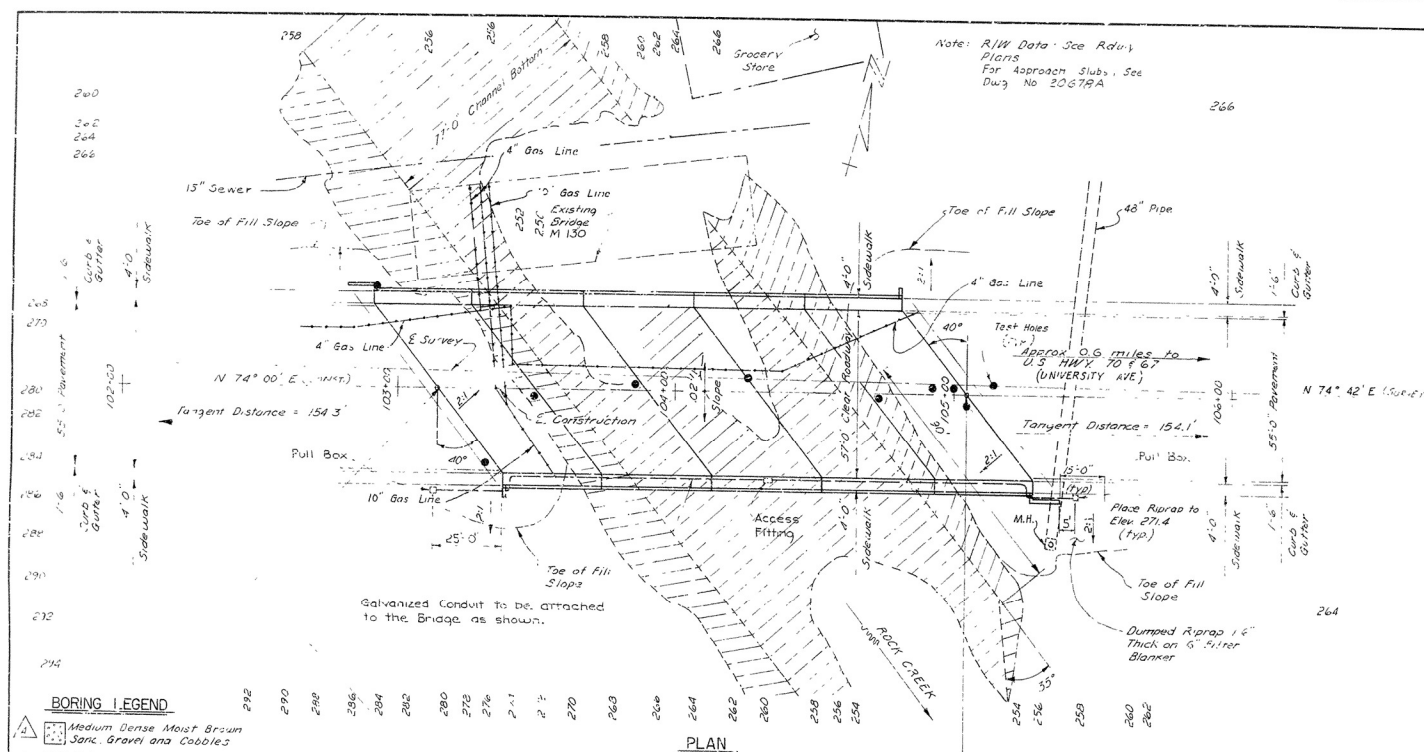
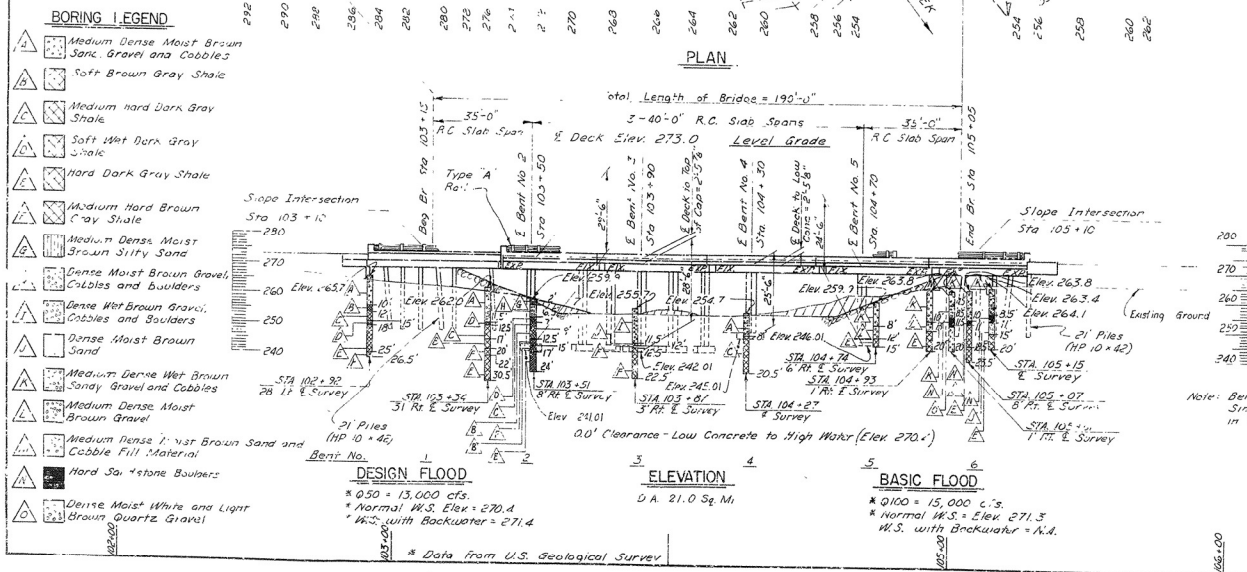

DATE REVISED	DATE FILED	DATE REVISED	DATE FILED	FED BUD NO	STATE	FED AID PROJ NO	SHEET NO	TOTAL SHEETS
				6	ARK.			
				JOB NO	60160		18	58
				①	5667 - LAYOUT - 20672			

[illegible]

SHEET 1 OF 2
LAYOUT OF
BRIDGE OVER ROCK CREEK
POCK CREEK BRIDGE & APPRS. (L.R.
PULASKI COUNTY
ROUTE 5 SEC. 9
ARKANSAS STATE HIGHWAY COMMISSION
LITTLE ROCK, ARK.
DRAWN BY: TEB DATE: 1-22-75
CHECKED BY: PJM DATE: 1-31-77 SCALE: 1" = 40'-0"
DESIGNED BY: CBE DATE: 1-25
BRIDGE NO. 5667 DRAWING NO. 20672